

6168700 N

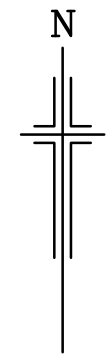

6168600 N
296400 E

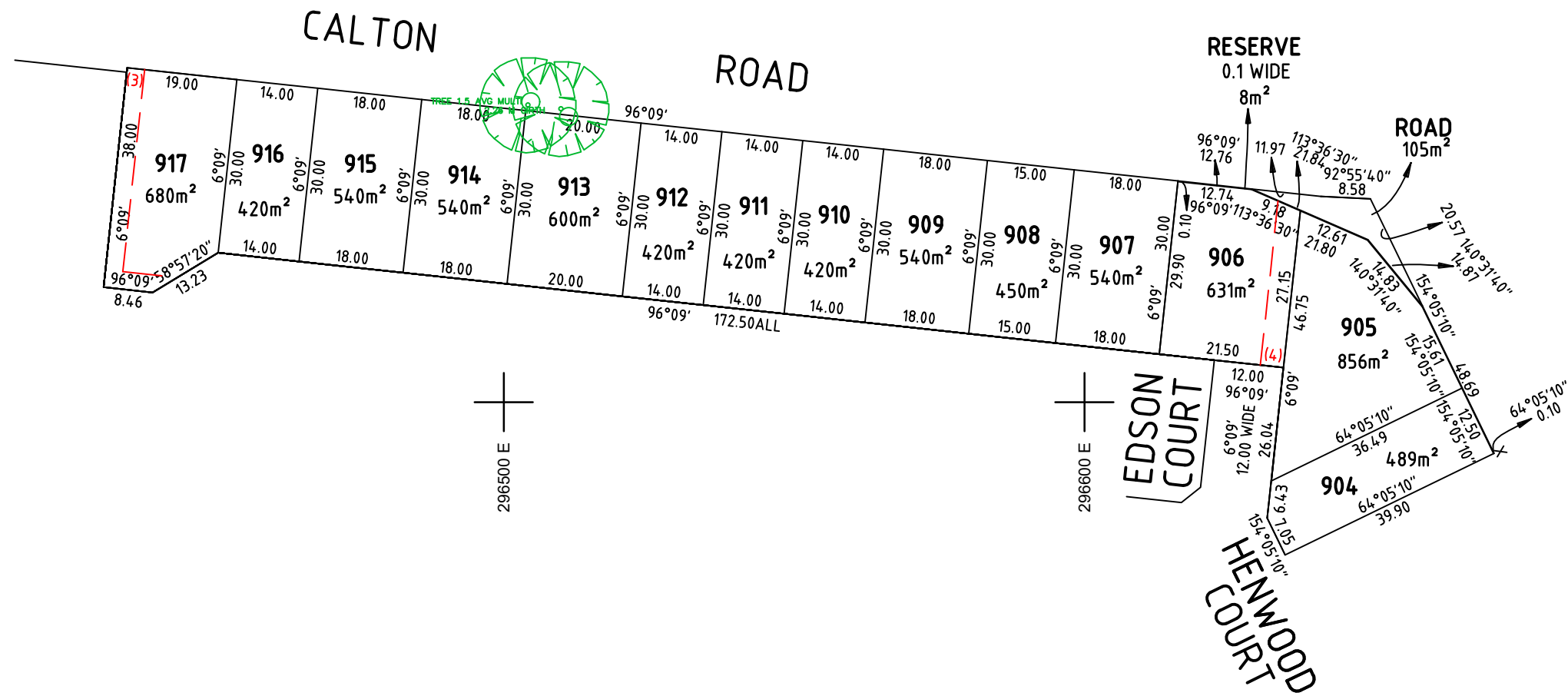
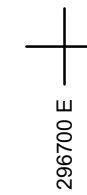
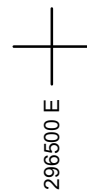

BL	13/07/2016	STAGE 9B - LOT 579	DEL	
BM	8/08/2016	STAGE 9B - LOT 570	DEL	
BN	16/08/2016	STAGE 9C - LOTS 5 & 6	DEL	
BP	23/08/2016	STAGE 9C - LOT 17 RENUMBERED TO 546	DEL	
BQ	21.07.2020	STAGE 9C RENUMBERED	DEL	
REV	DATE	DESCRIPTION	CALC	FIELD
ADDITIONS, AMENDMENTS AND APPROVALS				



1:1000

COORDINATES:	SURVEY:
HEIGHT DATUM:	DRAWN: DEL 12/01/11
DATA FILE:	
FLD/LVL BOOK:	CHECKED:

Alexander & Symonds Pty Ltd
11 King William Street Kent Town,
South Australia 5067
PO Box 1000 Kent Town, SA 5071
ABN 93007 753 988

T (08) 8130 1666
F (08) 8362 0099
W www.alexander.com.au
E adelaide@alexander.com.au

+ Property + Land Development +
+ Construction + Mining +
+ Spatial Information Management +



SPRINGWOOD EAST RIDING STAGE 9C PEGGING PLAN

DRAWING No.	SHEET	REVISION
A010816CAD EAST	1 OF 1	BQ