

**SERVICES LEGEND:**

- PROPOSED DRIVEWAY LOCATION (S-SINGLE, D-DOUBLE)
- ZERO LOT LINE
- SIDE ENTRY PIT (SEP)
- JUNCTION BOX (JB)
- GRATED INLET PIT (GIP)
- FIELD GULLY (FG)
- ALLOTMENT CONNECTION (TYPE 1) (SD-220)
- STORMWATER INSPECTION OPENING
- EXTENT OF WORK STAGE 1
- STORMWATER PIPE - RCP PIPE
- STORMWATER PIPE - UPVC PIPE
- FUTURE STORMWATER PIPE
- SEWER CONNECTION
- FUTURE SEWER CONNECTION
- SEWER MAIN
- POTABLE WATER
- RECYCLED WATER
- FUTURE SEWER MAIN
- POTABLE WATER
- RECYCLED WATER
- EXISTING STORMWATER PIPE
- EXISTING SEWER CONNECTION
- EXISTING SEWER MAIN
- EXISTING WATER MAIN
- SEWER MAINTENANCE HOLE
- SEWER INSPECTION OPENING
- ELECTRICAL PIT (NOTE REFER ELECTRICAL DRG. TO CONFIRM FINAL LOCATION. TYPICAL)
- ELECTRICAL PIT (CORNER ALLOTMENTS)
- ELECTRICAL PIT - P7 IN FOOTPATH
- POTABLE & RECYCLED WATER CONNECTION
- POTABLE WATER CONNECTION IN CAST IRON BOX
- PUBLIC LIGHT POLE
- TRANSFORMER/SWITCHING CUBICLE EASEMENT
- IRRIGATION CONDUIT 150 DIA UPVC CLASS S4 (IN ROADS) 750MM MIN. COVER
- IRRIGATION CONDUIT 100 DIA UPVC (UNDER FOOTPATHS)
- EXISTING UNDERGROUND ELECTRICAL CABLE
- EXISTING ELECTRICAL POLE AND OVERHEAD SERVICES
- INTERFACE TO EXISTING
- 6.0m SETBACK LINE

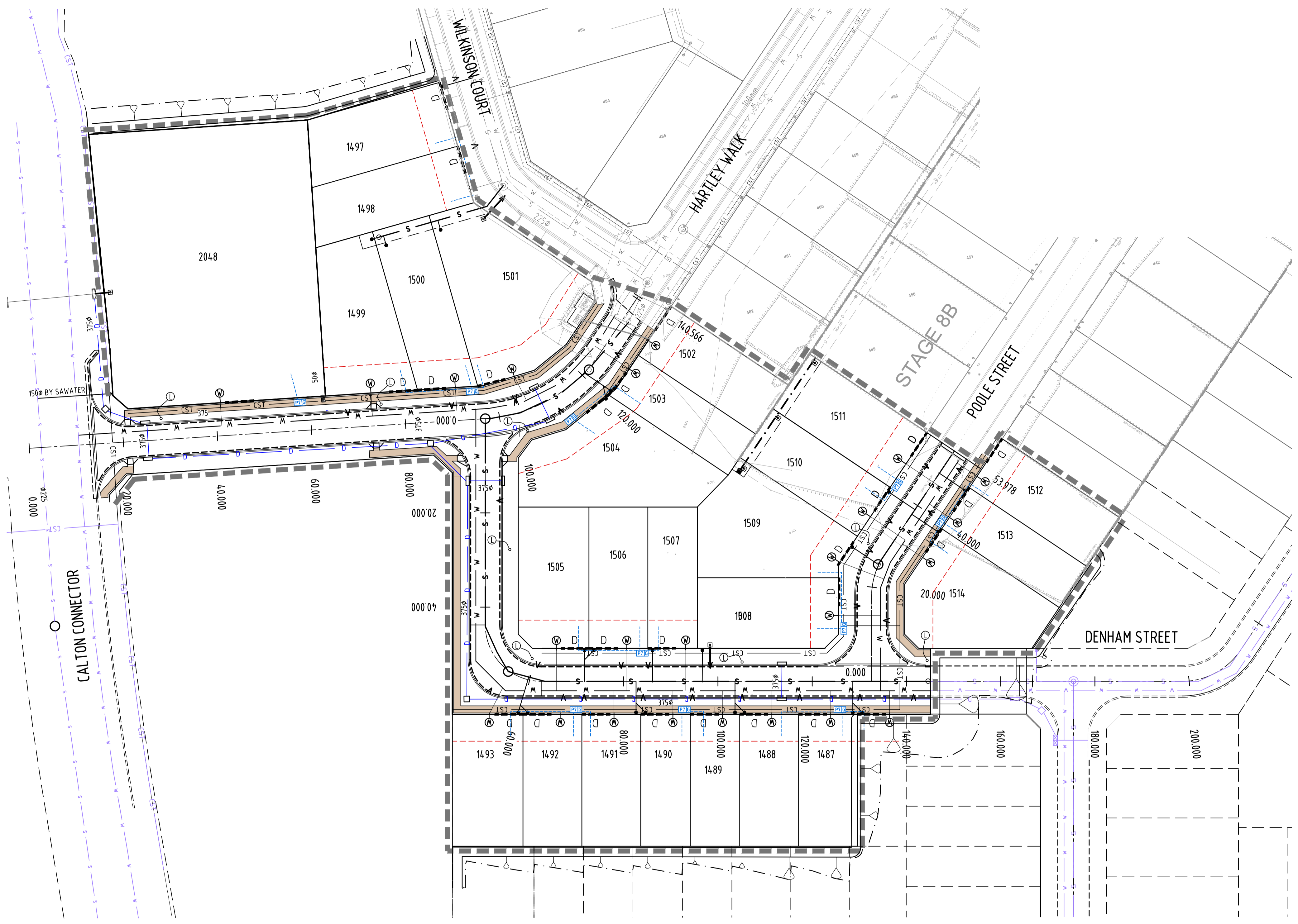

I:\2007\0586\2007\070975-Gawler East\Drawings\Stage 1\VC2A-003.dwg, B. 12/3/2020 2:41 PM, Scanned

When sheet printed full size, the scale bar is 100mm.  
 0 50 100mm

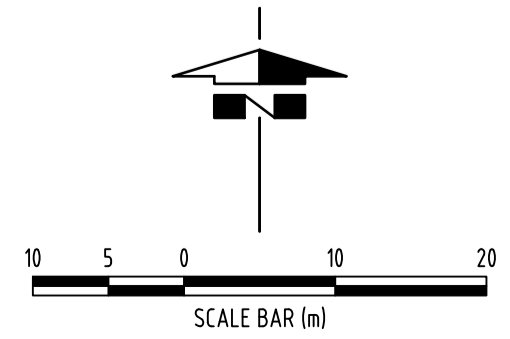

**INFORMATION ISSUE**  
NOT FOR CONSTRUCTION

REV.	DATE	DESCRIPTION	DRAFT	ENG.	CHKD
A	05.03.20	PRELIMINARY ISSUE	SRC	SM	
B	12.03	PRELIMINARY ISSUE	SRC	SM	

**WGA**  
 WALLBRIDGE GILBERT  
 AZTEC  
 60 Wyatt Street, Adelaide  
 South Australia 5000  
 Telephone 08 8223 7433  
 Email adelaide@wga.com.au

**DRAFT**

**SPRINGWOOD - VILLAGE CENTRE**  
**GAWLER EAST - STAGE 1**

**SERVICES PLAN**

<b>A1</b>	<b>DRAWING NUMBER</b>	<b>Job Number</b>	<b>Sheet No.</b>
Design SRC	Drawn SRC	<b>WGA070975-VC2A-003</b>	<b>B</b>