

**LEGEND:**

- 337.0 EXISTING CONTOURS
- DESIGN CONTOURS (200mm INTERVALS)
- EXTENT OF WORK STAGE 1
- DESIGN PAD LEVEL
- STORMWATER PIPE - RCP PIPE
- STORMWATER PIPE - UPVC PIPE
- FUTURE STORMWATER PIPE
- STORMWATER DRAINAGE PIT NUMBER
- 150 KERB AND GUTTER (SD-101)
- 150 OUTFALL KERB & TRAY (SD-103)
- 150 BARRIER KERB (SD-108)
- EDGE BEAM (SD-109)
- SPOON DRAIN (SD-104)
- KERB RAMP (TYPE 1) (SD-320)
- EXPOSED AGGREGATE PATH (SD-307)
- EXPOSED AGGREGATE PATH (SD-310)
- IRRIGATION CONDUIT REQUIRED UNDER ALL FOOTPATHS, DRIVEWAYS & PRAM RAMP
- DOUBLE SIDE ENTRY PIT (TYPE 2) (SD-207) WITH DEFLECTORS
- JUNCTION BOX (TYPE 1) (SD-200)
- GRATED INLET PIT (TYPE 2) (SD-203)
- FIELD GULLY PIT (SD-205)
- ALLOTMENT CONNECTION (TYPE 1) (SD-220)
- DRAINAGE OUTLET KERB INSERT (SD-213)
- KERB OPENING (REFER TO SH24)
- KERB TRANSITION OVER 2.0m
- FUTURE RETAINING WALL
- TRANSFORMER/SWITCHING CUBICLE EASEMENT
- PUBLIC LIGHT POLE
- INTERFACE TO EXISTING
- DRIVEWAY LOCATION & INVERT
- STREET SIGNS
- RETAINING WALL
- 6.0m SETBACK LINE
- LEVEL 1 CONTROLLED FILL UNDER SUPERVISION BY NATA ACCREDITED GEOTECHNICAL TESTING AUTHORITY
- ASPHALT PAVEMENT
- LANDSCAPING (BY OTHERS)

**NOTES:**

1. ALL DRAWINGS TO BE READ IN CONJUNCTION WITH THE LANDSCAPE ARCHITECTS DRAWINGS, OTHER CONSULTANTS DRAWINGS & THE SPECIFICATION.
2. ALL UPVC STORMWATER PIPES ARE TO BE SEWER CLASS 'SN'. U.N.O.
3. ALL R.C. STORMWATER PIPES ARE TO BE CLASS '2' WITH BEDDING TYPE 'HS2'. U.N.O.
4. ALL EXISTING SERVICES ARE TO BE LOCATED BY THE CONTRACTOR PRIOR TO COMMENCEMENT OF WORK AT CONTRACTORS COST.
5. ALL ROAD BATTERS IN ALLOTMENTS TO BE LEVEL 1 CONTROL FILL.
6. ALL ROADSIDE BATTERS & DISTURBED AREAS TO BE HYDROSEEDDED.

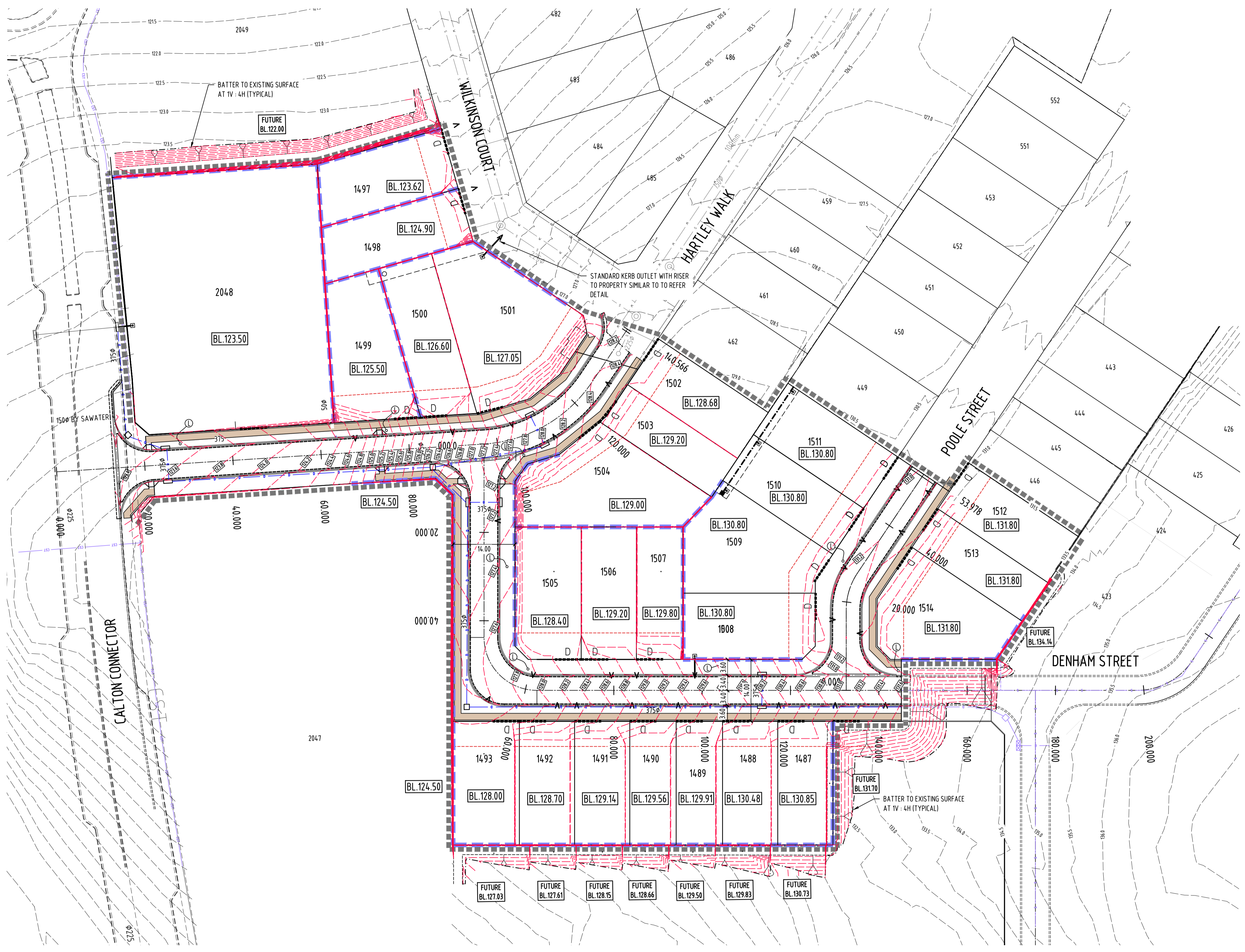

When sheet printed full size, the scale bar is 100mm.

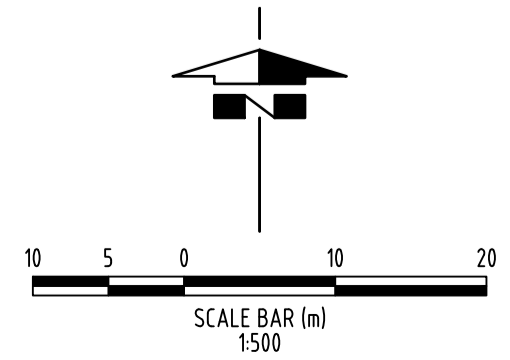

INFORMATION ISSUE  
NOT FOR CONSTRUCTION

REV.	DATE	DESCRIPTION	DRAFT	ENG.	CHKD
A	05.03.20	PRELIMINARY ISSUE	SRC	SM	
B	12.03	PRELIMINARY ISSUE	SRC	SM	

**WGA**  
WALLBRIDGE GILBERT  
AZTEC  
60 Wyatt Street, Adelaide  
South Australia 5000  
Telephone 08 8223 7433  
Email adelaide@wga.com.au

**DRAFT**

**SPRINGWOOD - VILLAGE CENTRE  
GAWLER EAST - STAGE 1**

**ROADS & STORMWATER PLAN**

**A1** DRAWING NUMBER  
Job Number Sheet No. Rev.

Design SRC Drawn SRC **WGA070975-VC2A-002** **B**

I:\2007\0956\2007\070975-GawlerEast\Drawings\Stage 1\VC2A-002.dwg, B. 12/03/2020 4:21 PM, Sscmsh